



SIDE SPREAD CONTROL

SIDESPREAD CONTROL™

Patent U.S. 10,993,368

Your Earthway spreader includes a patented feature to prevent fertilizer from being spread to the left side. Unlike competitor designs that waste the fertilizer, side spread control keeps unneeded fertilizer off sidewalks, driveways, and parking lots. Read **OPERATING INSTRUCTIONS** (Page 7) to activate this feature.

PRIOR TO ASSEMBLY, YOU WILL NEED:

7/16" and 10mm Wrench



7/16" or 10mm Ratchet

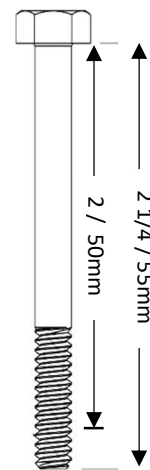
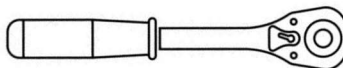

HELPFUL HINTS

- ☑ Read the directions before assembly.
- ☑ If your spreader does not spread evenly, be sure "FRONT" on the GEARBOX points to the front of the spreader. **The impeller must turn clockwise when pushing forward.** Reversing the GEARBOX during assembly will negatively impact spread quality.
- ☑ Your spreader is calibrated for three miles per hour, which is a brisk walking speed. Slower or faster speeds will change the spread pattern. Wet fertilizer will also change the spread pattern and flow rate. **Do not use powdered materials as it will damage the gearbox.**
- ☑ Gears are permanently lubricated at the factory. Do not open the GEARBOX or dirt may enter.

SPREADER ASSEMBLY INSTRUCTIONS

Step 1: Remove the spreader and parts from the carton and remove protective wrap from unit.

Step 2: Remove the two bottom bolts from the DRAW BAR.



Step 3: Rotate the DRAW BAR down and attach the DRAW BAR to the FRAME BRACES with the two bolts you just removed.

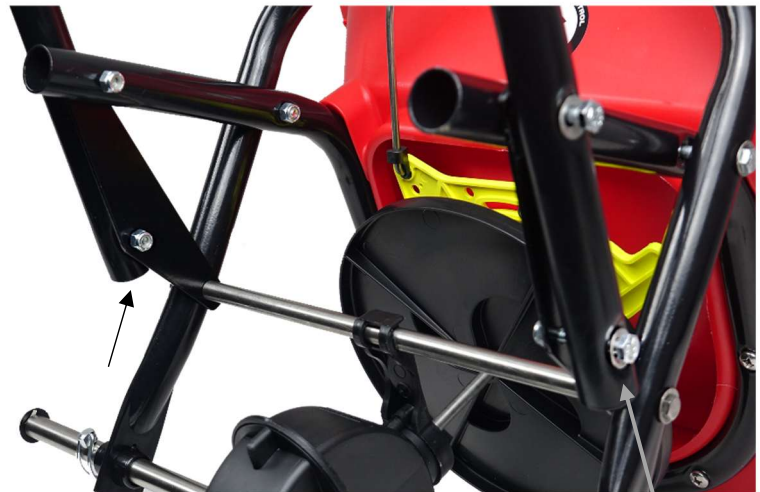

Step 4: Flip the hopper over and remove the axle plugs, hog ring and spring clip



Step 5: Install the DRIVE WHEEL onto the AXLE and align it with the SPRING CLIP. Then Install the COAST WHEEL onto the AXLE fully, then using the outside HOG RING hole



Step 6: Now remove the PIVOT BRACKET from THE LOWER HANDLES. Keep the 1/4 -20 x 2" (M6 X 1 X 50MM) bolts and locknuts for use in reinstallation.



Step 7: Install HANDLE SHAFT INTO LOWER HANDLES and then reattach the PIVOT BRACKET assembly as shown onto the LOWER HANDLES using two 1/4 -20 x 2" (M6 X 1 X 50MM) bolts and locknuts. **TIGHTEN ALL REMAINING BOLTS AND NUTS NOW.**

Step 8: Remove one 1/4-20 (M6 X 1) Hex Nut from the CONTROL ROD. With your hand push the shutoff plate under the hopper to the fully open position. Next, push LEVER forward to setting "0" to help align the CONTROL ROD with hole in PIVOT BRACKET, pull LEVER backward to setting "30" to insert CONTROL ROD through hole in PIVOT BRACKET. Now install 1/4-20 (M6 X 1) regular nut on to CONTROL ROD and tighten against the L-Bracket.

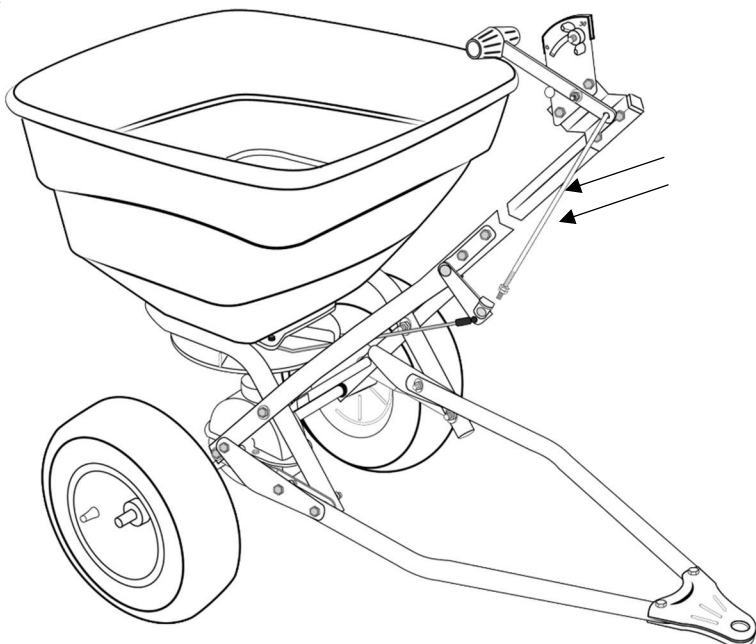

Step 9: Insert Hopper Screen and lock into place

Step 10: Use the hopper cover to cover your product after loading.



OPERATING INSTRUCTIONS

- ☑ Obtain the proper setting for the material to be used from the enclosed SETTING MATRIX included with this spreader, or from our website under the MANUALS SECTION.
- ☑ Set the stop bolt, on the rate gauge assembly to the proper rate setting.
- ☑ While pushing the spreader forward, pull the control lever back to stop the bolt, to stop spreading, push the lever forward to close flow holes before you stop moving.
- ☑ When finished, empty any remaining material from the hopper, rinse the spreader and apply a coating of light oil to all metal parts. The gearbox is sealed and factory lubricated.

SIDESPREAD CONTROL™

The **SideSpread-Control** is a patented innovation that is superior to side deflectors. Side deflectors block material leaving the impeller. This blocked material is now consolidated into a 2-3" (5-7.6cm) wide path on the left inside wheel of your spreader. This equates to wasted fertilizer, dark green stripes, and in some cases, this extra fertilizer (seven times) will damage the lawn.

SideSpread-Control maintains the correct application rate while not placing material on driveways, sidewalks, flowerbeds, or worse, the storm drains in your street. This saves you money and keeps you from damaging your lawn.

To engage **SideSpread-Control**:

- 1) Locate the lever on under the right side of the hopper.
- 2) Slide the control lever from the front to the back.
- 3) Position the left wheel of your spreader 6"-12" (15-30cm) from the sidewalk, flowerbed, or driveway and spread as normal.
- 4) When you have completed this spreading pass, close the control lever to "0", and then open the **SideSpread-Control™** by sliding the control lever from the back to the front, for a **FULL**, 180° spread pattern.

Look for **EarthWay Broadcast Spreader** models on the bag for settings. If there is none listed, please use the comparison chart below as a guide to estimate your spreader setting. These settings are approximate and intended as a guide only.



Variations in physical characteristics of material applied, walking speed and surface roughness may require slightly different spreader settings. Due to the above conditions, the manufacturer makes no warranty as to the uniformity of coverage actually obtained from settings listed.

BAG WEIGHT	SQ/FT COVERAGE		
	5,000	10,000	15,000
5 LBS.	1.0	0.5	0.3
10 LBS.	2.0	1.0	0.7
15 LBS.	3.0	1.5	1.0
18 LBS.	3.6	1.8	1.2
20 LBS.	4.0	2.0	1.3
25 LBS.	5.0	2.5	1.7
30 LBS.	6.0	3.0	2.0
35 LBS.	7.0	3.5	2.3
40 LBS.	8.0	4.0	2.7
45 LBS.	9.0	4.5	3.0
50 LBS.	10.0	5.0	3.3

Example Bag Weight Chart to calculate the number of lbs. per 1,000 square feet.

T150 Tow Behind SPREADER SETTING MATRIX

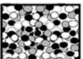
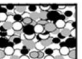
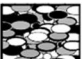
GRANULAR MATERIAL

Standard-Output Red Tray				Medium (HALF BB) 		Large (BB) 		EXTRA LARGE (ROCK SALT) 					
PARTICLE SIZES: Fine/Small (SAND)	LBS. PER 1,000 SQUARE FEET	SETTING	SPREAD WIDTH FT	SPREAD METERS	SETTING	SPREAD WIDTH FT	SPREAD METERS	SETTING	SPREAD WIDTH FT	SPREAD METERS	SETTING	SPREAD WIDTH FT	SPREAD METERS
1 LB.	7	18'	5.486m	9	24'	7.135m	14	36'	10.972m	17	37'	11.277m	
2 LBS.	10	18'	5.486m	13	24'	7.135m	18	36'	10.972m	22	37'	11.277m	
3 LBS.	13	18'	5.486m	16	24'	7.135m	23	36'	10.972m	24	37'	11.277m	
4 LBS.	14	18'	5.486m	20	24'	7.135m	27	36'	10.972m	26	37'	11.277m	
5 LBS.	16	18'	5.486m	22	24'	7.135m	30	36'	10.972m	28	37'	11.277m	
6 LBS.	18	18'	5.486m	25	24'	7.135m	23 = 2 pass	36'	10.972m	29	37'	11.277m	
7 LBS.	20	18'	5.486m	27	24'	7.135m	25 = 2 pass	36'	10.972m	30	37'	11.277m	
8 LBS.	22	18'	5.486m	28	24'	7.135m	27 = 2 pass	36'	10.972m	26 = 2 pass	37'	11.277m	
9 LBS.	24	18'	5.486m	30	24'	7.135m	28 = 2 pass	36'	10.972m	27 = 2 pass	37'	11.277m	
10 LBS.	26	18'	5.486m	22 = 2 pass	24'	7.135m	30 = 2 pass	36'	10.972m	28 = 2 pass	37'	11.277m	

GRASS SEED

LBS. PER 1,000 SQUARE FEET	FINE		COARSE	
	SETTING	SPREAD WIDTH FT	SETTING	SPREAD WIDTH FT
2 LBS.	14	8'	22	14'
3 LBS.	16	8'	25	14'
4 LBS.	18	8'	28	14'
5 LBS.	20	8'	30	14'

Calibration: Start by ensuring that your spreader calibration is correct. Make sure the drop holes in the **Standard -Output Tray** are fully open when the Rate Control handle is on #30. If not, please adjust control rod at the pivot to allow for a full open hopper holes with the handle at position at #30.

ONE YEAR WARRANTY

Limited Warranty

EarthWay Products, LLC. provides this limited warranty that this product is free of defects in original workmanship and materials for a period of one year to the end user with the original purchase receipt. If a manufacturing non-conformance is found, EarthWay Products, LLC. at its discretion will repair or replace the part(s)/product at no charge provided the failure is not the result of incorrect installation, mishandling, misuse, tampering, improper storage, or normal wear and tear as determined by EarthWay. Due to the corrosive nature of most fertilizers and ice melt products, EarthWay Products, LLC. makes no warranty against and specifically excludes part(s) or product degradation or failure due to corrosion or its effects.

EarthWay at its discretion may require that the part(s) or product be returned along with the original purchase receipt for examination and compliance with the terms of this limited warranty. Do not return any product without first receiving authorization from EarthWay Products, LLC. IN NO EVENT SHALL EITHER PARTY BE LIABLE TO THE OTHER FOR SPECIAL, INDIRECT, INCIDENTAL, OR CONSEQUENTIAL DAMAGES, EVEN IF SUCH PARTY SHALL HAVE BEEN ADVISED OF THE POSSIBILITY OF THE SAME.

To seek remedy under this limited warranty, contact EarthWay Products, LLC. at support@earthway.com or write to EarthWay Products, LLC. 1009 Maple Street, Bristol, IN 46507, and describe the nature of the manufacturing defect. SPECIFIC LIMITATIONS: This limited warranty covers only the part(s) or product; any labor charges associated with the repair or replacement of non-conformances are specifically excluded.

The above-listed warranty procedure is a condition precedent to bringing any legal action to enforce this limited warranty. Any action to enforce any portion of this limited warranty must be commenced within ninety days after the expiration of the limited warranty coverage period. Any performance of repairs will not suspend this limitation period from expiring unless state law provides otherwise. Any performance of repairs after the limited warranty coverage period has expired, or performance of repairs regarding anything excluded from coverage under this limited warranty shall be considered “goodwill” repairs, and they will not change the express terms of this limited warranty or extend the limited warranty coverage period.

Exclusive jurisdiction for deciding legal disputes relating to alleged breach of warranty or representations of any nature relating to this limited warranty must be filed in the courts of Elkhart County within the State of Indiana. Any and all claims, controversies, and causes of action arising out of or relating to this limited warranty, whether sounding in contract, tort, or statute, will be governed by the laws of the State of Indiana, without giving effect to any choice or conflict of law provision or rule.

NO OTHER WARRANTY, EXPRESS, IMPLIED, OR STATUTORY, SHALL APPLY, INCLUDING, BUT NOT LIMITED TO, ANY IMPLIED WARRANTY OF MERCHANTABILITY, APPLICATION, OR FITNESS FOR A PARTICULAR PURPOSE, OR ANY OTHER WARRANTY OBLIGATION ON THE PART EARTHWAY, AND ALL SUCH WARRANTIES ARE EXPRESSLY DISCLAIMED. In the event that applicable law prevents the disclaimer of any implied warranties, then such implied warranty shall be limited to the fullest extent permitted by law. Without limiting the foregoing, if applicable prevents the disclaimer of any such implied warranties, this limited warranty limits the period of time in which a claim for breach of implied warranties, including but not limited to the implied warranty of merchantability or fitness for a particular purpose, may be filed. In such event, any claim for breach of implied warranty must be brought before the expiration of this express limited warranty's one-year term.

CUSTOMER SERVICE

SUPPORT@EARTHWAY.COM | www.EARTHWAY.com | 1009 Maple Street, Bristol, IN 46507

HOW TO ORDER SPARE PARTS – CALL or EMAIL:

TURF DEPOT 800-305-9255 or earthway@turfdepot.com

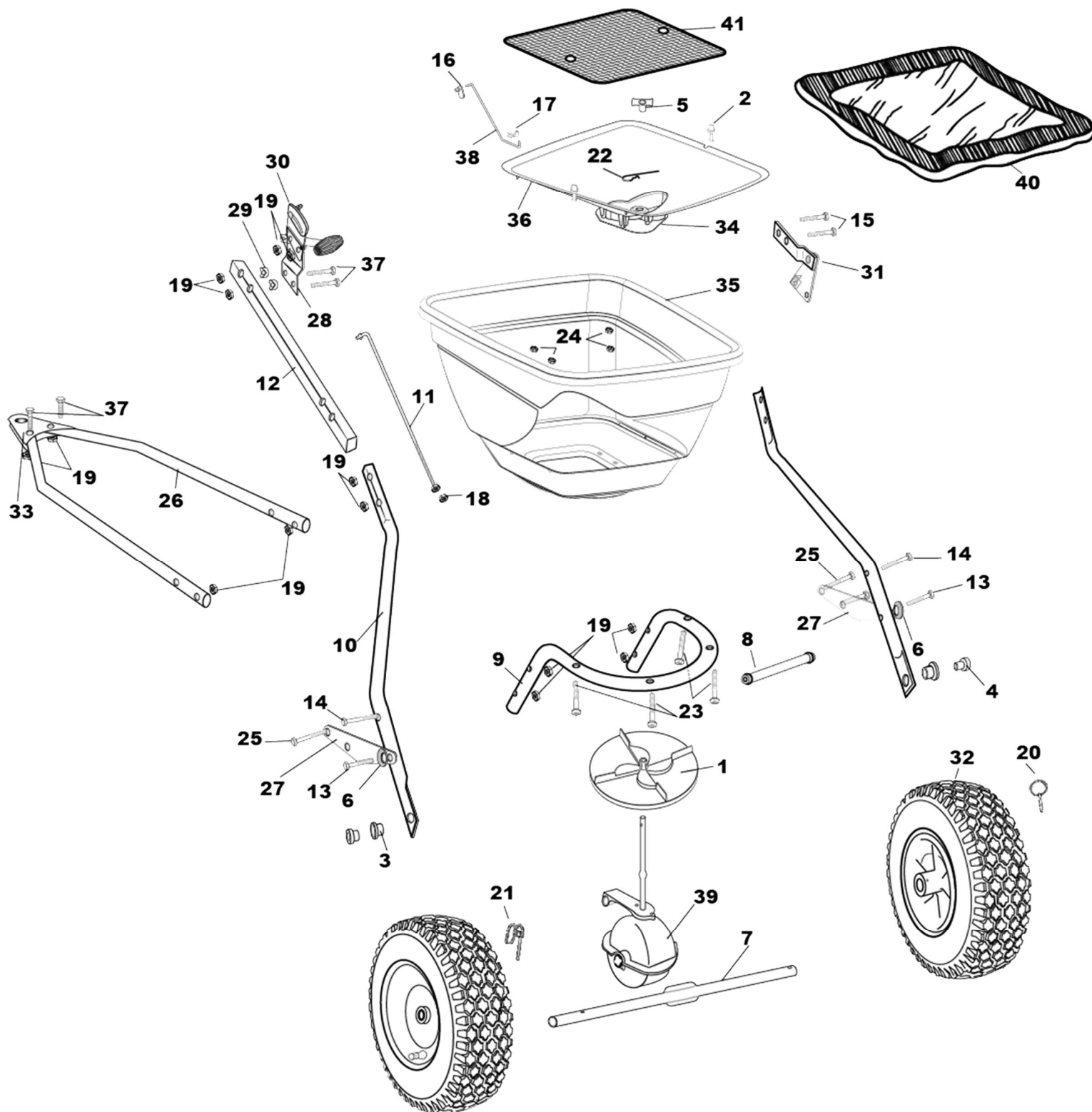

T150 Spreader Parts List					
SERIES	PART #	DESCRIPTION	SERIES	PART #	DESCRIPTION
1	12110	IMPELLER 9" ROUND DISHED	22	33117	AGITATOR
2	F12135	1/4 TURN FASTENER FLEX SELECT	23	36214	1/4-20 X 1 1/2" PHPMS S.S.
3	12148	AXLE BEARING	24	36300	1/4-20 NYLON INSERT LOCKNUT S.S.
4	12152	AXLE BUSHING	25	31100	1/4-20 X 1 1/2 HHCS
5	12209	HOPPER BUSHING	26	F21213	DRAW BAR FLEX-SELECT
6	36404	1/4 CUPPED WASHER S.S.	27	F44249	FRAME BRACE BLACK
7	24500	AXLE	28	F44246	GAUGE MOUNTING BRACKET
8	25228	CROSS BRACE	29	F12144	V SPACER FLEX-SELECT
9	25108	FRAME	30	60298	GAUGE & LEVER ASSEMBLY
10	25222	LOWER HANDLE SQ	31	60300	PIVOT & BRACKET ASSEMBLY
11	F42263	13" CONTROL ROD	32	70138	13" PNEUMATIC WHEEL
12	F25606	SQUARE CONTROL SUPPORT TUBE	33	F44215	HITCH PLATE ea.
13	36239	BOLT M6-1 X 35MM HHCS SS	34	F13130	STANDARD OUTPUT TRAY
14	31106	1/4-20 X 2 1/4" HHCS ZINC	35	F13106	150 LB HOPPER
15	31120	1/4-20 X 2" HHCS ZINC	36	F13130	STANDARD OUTPUT FLEX-SELECT TRAY KIT
16	31127	ROD CLIP	37	31114	1/4-20 X 1 3/4" HHCS ZINC
17	31127	ROD CLIP	38	F44251	PIVOT ROD STD OUTPUT FLEX-SELECT
18	32100	1/4-20 HEX NUT ZINC	39	F60331	GEAR BOX ASSEMBLY TOW FLEX - SELECT
19	32103	1/4-20 NYLON INS LOCKNUT ZINC	40	F77130	RAIN COVER
20	33115	Spring Clip	41	F40003	SQUARE SCREEN FLEX-SELECT
21	33113	Hog Ring			