

6500W KENTUCKY HIGH-WHEEL CULTIVATOR

ASSEMBLY INSTRUCTIONS

EarthWay®
GARDEN

Congratulations on the purchase of this new Earthway High-Wheel Cultivator. Please contact us if you have any difficulty with assembly or operation of this product. We can be reached via the telephone at 800-294-0671 or 574-848-7491 Monday - Friday 9:00am ~ 4:00pm or visit us online at www.earthway.com The 6500W comes with **LIFETIME TECHNICAL SUPPORT**, email us at techsupport@earthway.com.

HELPFUL HINTS: READ THE DIRECTIONS BEFORE ASSEMBLY

The 6500W will require approximately 30 minutes to assemble with common hand tools.

- ✓ Remove and identify all loose parts from carton.
- ✓ Clean and dry your Cultivator thoroughly after each use.
- ✓ Coat all metal surfaces with a light oil to prevent corrosion and wood sealer to the handles

ASSEMBLY OF THE 6500W

Remove and identify all loose parts from carton

- Install handle bracket (20) to inside of wood handles (22). **NOTE:** Slight bend in handle bracket (20) to face outward and that you need to mount them so they face each other, see below right.
- Insert 5/16-18 x 1½" bolts (8) through holes in wood handles then through holes in handle bracket, fasten using 5/16-18 hex nut (12).
- Insert axle bolt (11) through hole in handle bracket (20). Now insert the bolt through hole in the straight end of frame (1). Place axle (2) into center of wheel (21). Now put axle bolt (11) through the axle (2), then put other frame (1) and other handle bracket (20) over axle bolt and fasten with 5/16 lock washer (14) and 5/16 hex nut (12).
- Insert 5/16-18 x 1¼" bolt (7) through hole in bottom of right tool support (6). Now put spacer (4) onto bolt (7) and install left tool support (5) and fasten with 5/16 hex nut (12).
- Put tool support assembly from Step IV above between frame (1) ends with spacer end down and curve toward wheel. Next fasten the frame (1) to tool support assembly with ¼-20 x 2" bolt (9) and ¼-20 locknut (13).
- NOTE:** Four holes in (5 & 6) are for adjustable height for easier operating. Now take wood handles (24) and attach to tool support supports (5 & 6) using 5/16-18 x 1½" bolt (8) and 5/16 hex nut (12).
- Now install cross brace (3) to wooden handles using #14 x 1¼" screws (10).

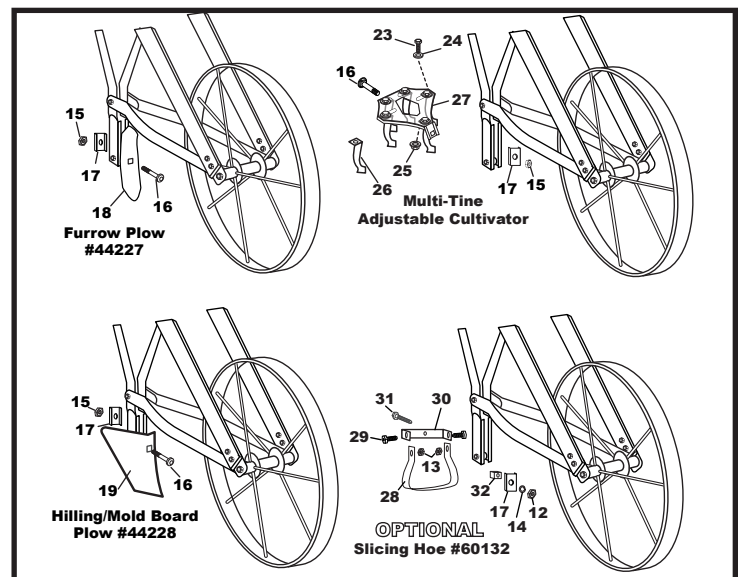
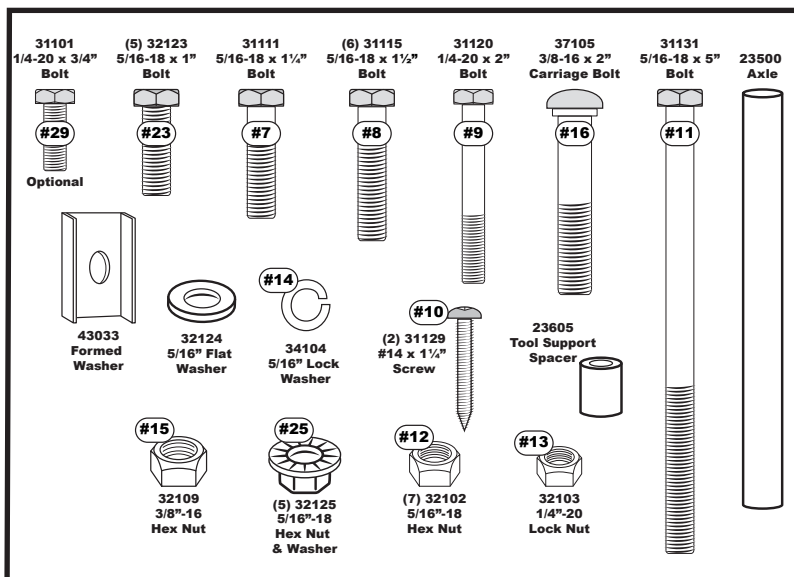
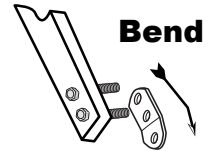
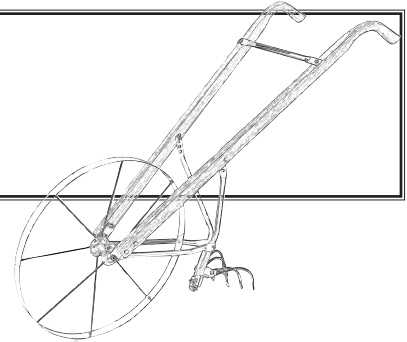

ASSEMBLY OF TOOLS (see above right)

FURROW PLOW

Place Furrow Plow in front of tool support slot. Put carriage bolt (16) through square hole in the plow and through slot in tool support. Next put formed washer (17) over carriage bolt (16) and tool support: fasten with lock nut (15) and tighten fully.

HILLING / MOLD BOARD PLOW

Place Hilling Plow in position shown above. Put carriage bolt (16) through square hole in plow and through slot in tool support. Next put formed washer (17) over carriage bolt (16) and tool support: fasten with lock nut (15) and tighten fully.

MULTI-TINE ADJUSTABLE CULTIVATOR

Assemble Multi-Tine as pictured above. Put carriage bolt (16) through rear of the mounting plate (27) and through tool support and then formed washer (17) and fasten with lock nut (15), tighten fully. Next, attach the tines (26) with bolt (23) through flat washer (24) and secure with hex nut (25), leave loose until you determine tine width as required. Tighten fully.

HOW TO ORDER PARTS

Call 1-800-294-0671 or 574-848-7491

Monday - Friday 8:30am - 4:00pm

or www.earthway.com/parts

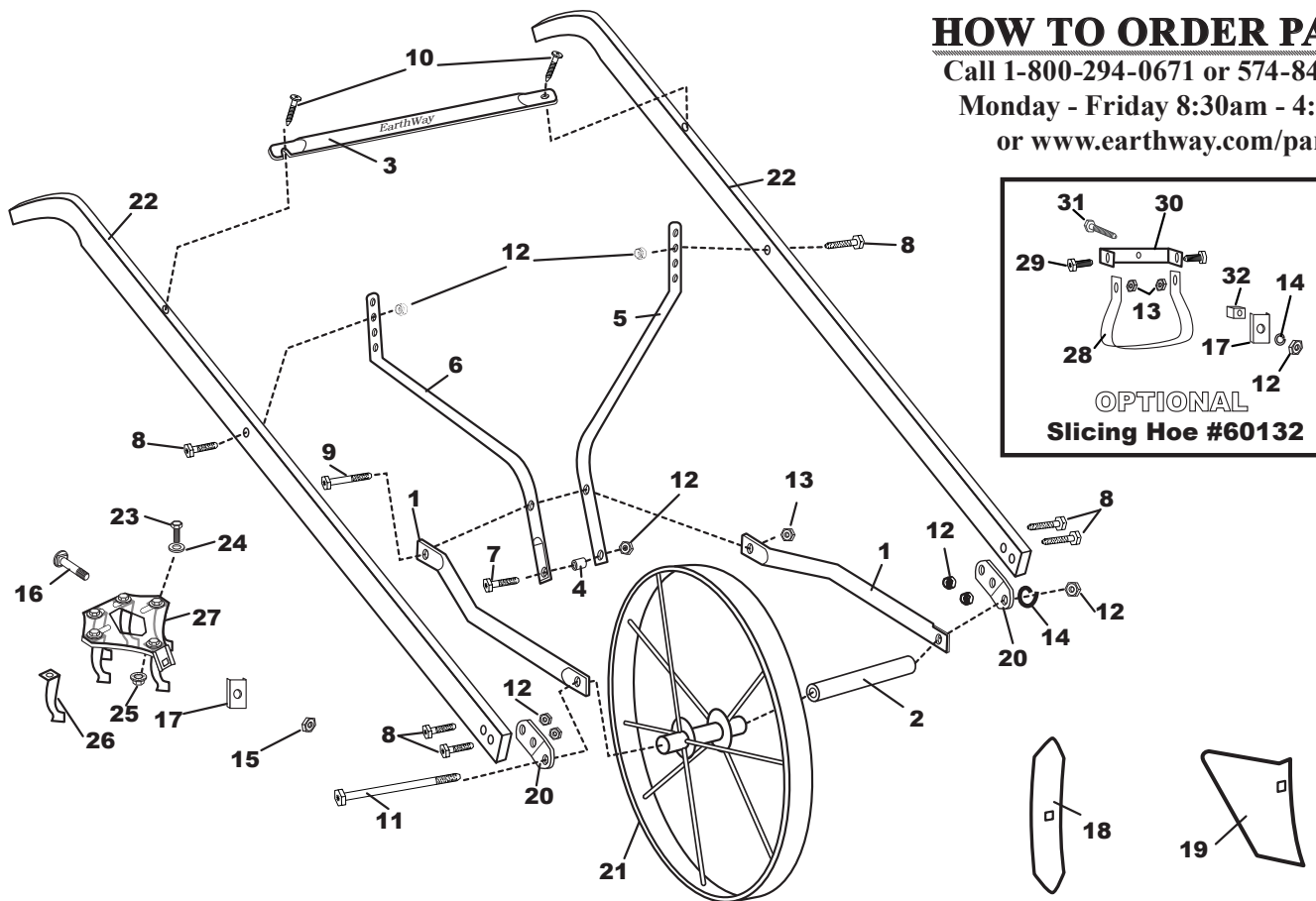

6500W KENTUCKY HIGH WHEEL CULTIVATOR

KEY #	PART #	DESCRIPTION	KEY #	PART #	DESCRIPTION
1	23104	FRAME (6500)	18	44227	FURROW PLOW (6500)
2	23500	AXLE (1001-B)	19	44228	HILLING (MOLDBOARD) PLOW (6500)
3	23604	CROSS BRACE (6500)	20	44266	HANDLE BRACKET (6500W)
4	23605	TOOL SUPPORT SPACER (6500)	21	60130	WHEEL ASSEMBLY 6500/6500W GLOSS BLACK
5	23610	LEFT TOOL SUPPORT (6500W)	22	77100	WOOD HANDLE 6500W - DRILLED
6	23611	RIGHT TOOL SUPPORT (6500W)	23	32123	5/16-18 X 1" HHMS ZINC
7	31111	5/16-18 X 1 1/4" HHMS ZINC	24	32124	5/16 ID X 11/16" OD FLAT WASHER
8	31115	5/16-18 X 1 1/2" HHCS ZINC	25	60132	5/16-18 HEX NUT WITH WASHER
9	31120	1/4-20 X 2" HHCS ZINC	26	60148	CULTIVATOR TINE (5 REQUIRED)
10	31129	#14 X 1 1/4 TYPE A PHPS ZINC"	27	60131	MOUNTING PLATE
11	31131	5/16-18 X 5" HHCS ZINC	OPTIONAL	60132	SLICING HOE ASSEMBLY
12	32102	5/16-18 HEX NUT ZINC	28	44244	SLICING HOE BLADE
13	32103	1/4-20 NYLON INS LOCKNUT ZINC	29	31101	1/4-20 X 3/4" HHMS ZINC
14	34104	5/16" SPLIT LOCK WASHER ZINC	30	44252	SLICING HOE BRACKET
15	36302	3/8-16 NYLON INSERT LOCKNUT ZINC	31	31125	5/16-18 X 2" HX TAP BOLT ZINC
16	37105	3/8-16 X 2" CARRIAGE BOLT ZINC	32	44253	TOOL ADAPTOR FOR SLICING HOE
17	43033	FORMED WASHER (6500)			

5-YEAR LIMITED WARRANTY

Earthway Products, Inc. warrants this product free of defects in original workmanship and materials for a period of 5-years to the end user with the original dated purchase receipt. If a manufacturing non-conformance is found, Earthway Products, Inc. at its discretion will repair or replace the part(s) or product at no charge provided the failure is not the result of incorrect installation, mishandling, misuse, tampering, or normal wear and tear as determined by Earthway. Earthway at its discretion may require that the part(s) or product be returned along with the original purchase receipt at owners' expense for examination and compliance with the terms of this warranty. Do not return any product without first receiving authorization from Earthway Products, Inc. To seek remedy under this warranty, contact Earthway Products, Inc. at 574-848-7491, techsupport@Earthway.com or write to Earthway Products, Inc. P.O. Box 547 Bristol, Indiana 46507 and describe the nature of the manufacturing defect.

SPECIFIC LIMITATIONS: This warranty covers only the part(s) or product; any labor charges associated with repair or replacement of non-conformances are specifically excluded. Due to the corrosive nature of most fertilizers and ice melt products, Earthway Products, Inc. makes no warranty against and specifically excludes part(s) or product degradation or failure due to corrosion or its effects. Clean and dry your seeder thoroughly after each use, as a preventative measure, coat all metal parts *inside and outside* with a light oil or silicon spray.