

CAUTION:

- Rainwater is not suitable for pets or human consumption. Any standing water will grow bacteria.
- Do not allow children to play in or around rain barrel. When full, water in the barrel will weigh 400lbs, Choose a level, sturdy foundation, that is away from children.
- Always keep lid closed. Sunlight will grow algae.
- Do not allow water to freeze in barrel – ice will expand and cause barrel to stretch and leak.

- 1** Locate the pipe tape and garden hose valve (inside barrel). Wrap about 4" of pipe tape around threads in the same direction (clockwise) you will be installing the valve. Insert valve threads into barrel threads, turn clockwise.

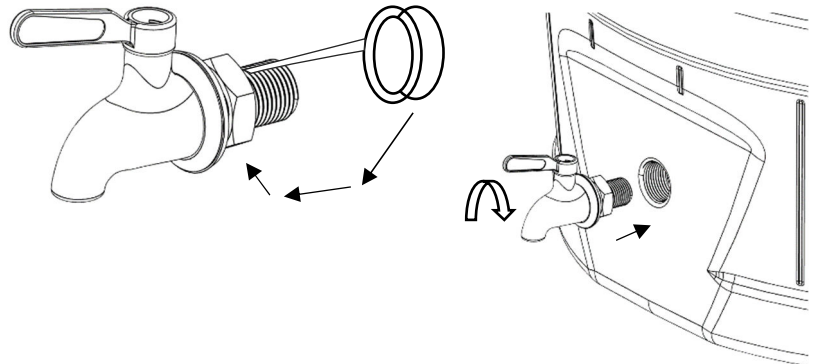

- 2** Install insect repellent screen with included fasteners if not using a 4" flexible downspout to fill barrel.

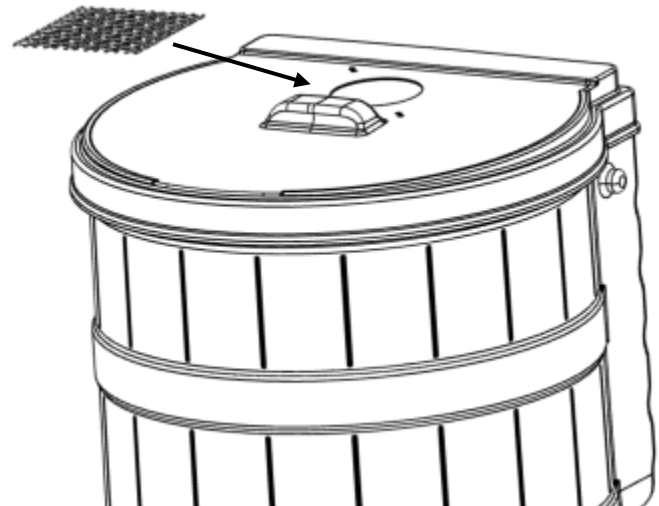

Thank you! Our EarthWay team appreciates your business.

The EarthWay rain barrel has the following innovative features:

- Removable lid – ability to clean barrel or completely empty for storage.
- Integrated 2"x 6" barrel cleats lock into treated lumber to be stable on standard treated lumber.
- Handle on lid blocks downspout flow to allow more water to enter barrel.
- Hole in lid is sized to accept common 4" plastic extendable downspout adapters.
- Insect screen can be attached to lid if not using a plastic 4" round downspout pipe.
- Integrated barrel side connectors to link multiple barrels together for more storage.
- Brass faucet valve resists corrosion.

OPTIONAL EQUIPMENT

- Optional: Your rain barrel was designed with cleats to lock into standard pressure treated 2"x6" lumber. This raises the barrel to allow a 1-gallon bucket to be placed under the valve. Visit your local hardware store for these optional materials (shown below).



- Optional kit P/N: 89017: Rain Barrel connector kit – to connect two or more rain barrels together.

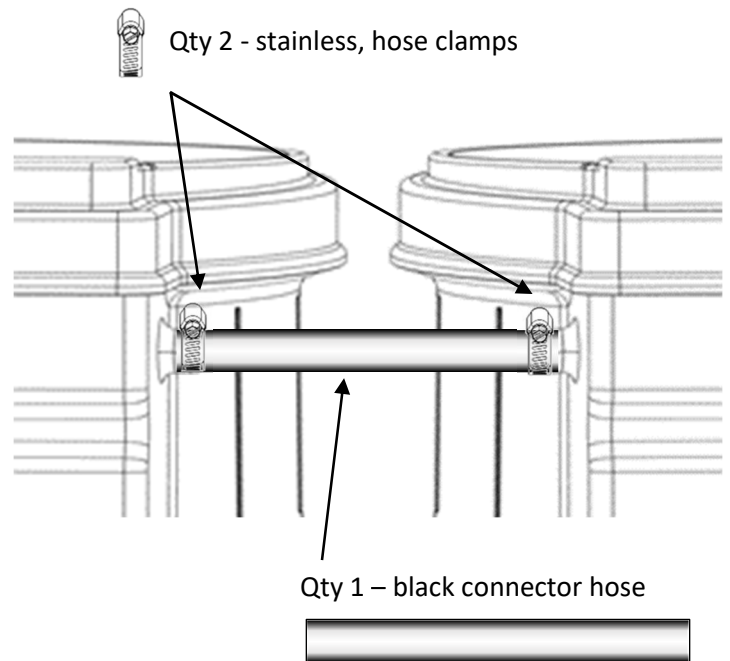

CUSTOMER SERVICE

574.848.7491 | SUPPORT@EARTHWAY.COM | www.EARTHWAY.com | 1009 Maple Street, Bristol, IN 46507

ONE YEAR WARRANTY

EarthWay Products, Inc. warrants this product free of defects in original workmanship and materials for a period of one year to the end user with the original purchase receipt. If a manufacturing non-conformance is found, EarthWay Products, Inc. at its discretion will repair or replace the part(s)/product at no charge provided the failure is not the result of incorrect installation, mishandling, misuse, tampering, freezing of water, or normal wear and tear as determined by EarthWay.

EarthWay at its discretion may require that the part(s) or product be returned along with the original purchase receipt for examination and compliance with the terms of this warranty. Do not return any product without first receiving authorization from EarthWay Products, Inc.

To seek remedy under this warranty, contact EarthWay Products, Inc. at 574-848-7491, support@earthway.com or write to EarthWay Products, Inc. 1009 Maple Street, Bristol, IN 46507 and describe the nature of the manufacturing defect. SPECIFIC LIMITATIONS: This warranty covers only the part(s) or product; any labor charges associated with repair or replacement of non-conformances are specifically excluded. EarthWay Products, Inc. makes no warranty against and specifically excludes part(s) or product degradation or failure due to corrosion or its effects.